



GENERAL INFORMATION
BLOCKING

Although other blocking patterns exist, the most commonly used are the following. The pattern numbers correspond to the numbers used in AAR Sections 1 and 6.

A. PATTERN 16

Chock block used mainly on wheeled vehicles.

B. PATTERN 30

Front chock block used mainly on tracked vehicles.

C. PATTERN 31

Rear chock block used mainly on tracked vehicles.

D. PATTERN 89

External side blocking used when flat car width allows.

E. PATTERNS 90 AND 91

Front supports, or stanchions, used with trailers and semi-trailers on flat cars.

F. ROAD WHEEL BLOCKS

One or two pieces of lumber 2'' by 4'' on top. Also called bogie wheel blocks, these are used on tracked vehicles to block the road wheels.

G. LATERAL BLOCKING

Usually used when the width of the flat car does not allow for side blocks. Often called interior side blocking since it provides lateral support on the inside of the tires or tracks.

NOTE: BLOCKING MAY BE FABRICATED USING ROUGH OR COMMERCIAL DRESSED LUMBER OF THE NOMINAL SIZES INDICATED ON EACH DRAWING.

GENERAL INFORMATION

PATTERN 16

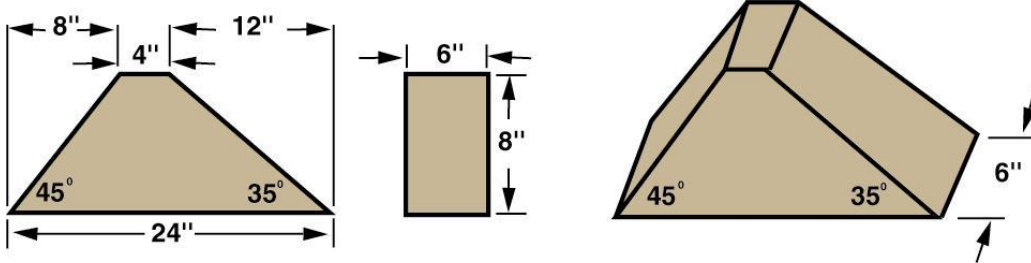

NOTE: LOCATE 45 DEGREES PORTION OF BLOCK AGAINST FRONT AND REAR OF WHEELS. SECURE HEEL OF BLOCK TO FLOOR WITH THREE 40-D (5'') NAILS AND TOENAIL THAT PORTION UNDER TIRE WITH TWO 40-D (5'') NAILS. USUALLY, 2 BLOCKS PER WHEEL ARE REQUIRED.

NOTE: PREDRILLING IS ADVISED TO PREVENT SPLITTING.

NOTE: AN 8" ALLOWANCE IS PROVIDED FOR WASTAGE

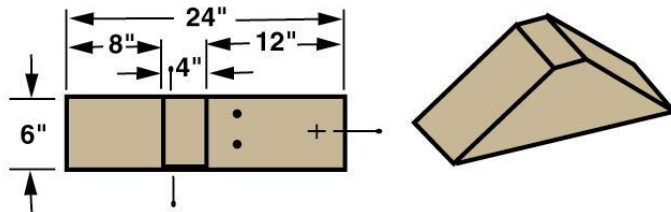
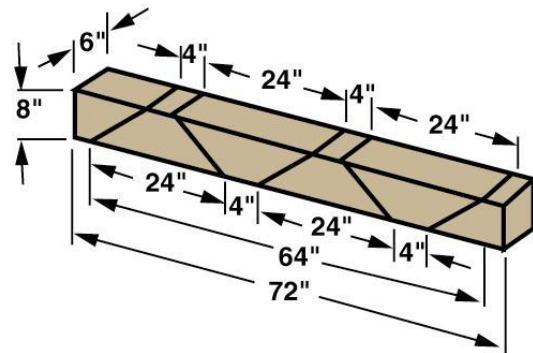

VERTICALLY DRIVEN FOR
LATERAL RESISTANCE

WHEEL

DIAGONALLY DRIVEN FOR
CHOCK PLACEMENT

TOENAILED

GENERAL INFORMATION
PATTERN 30

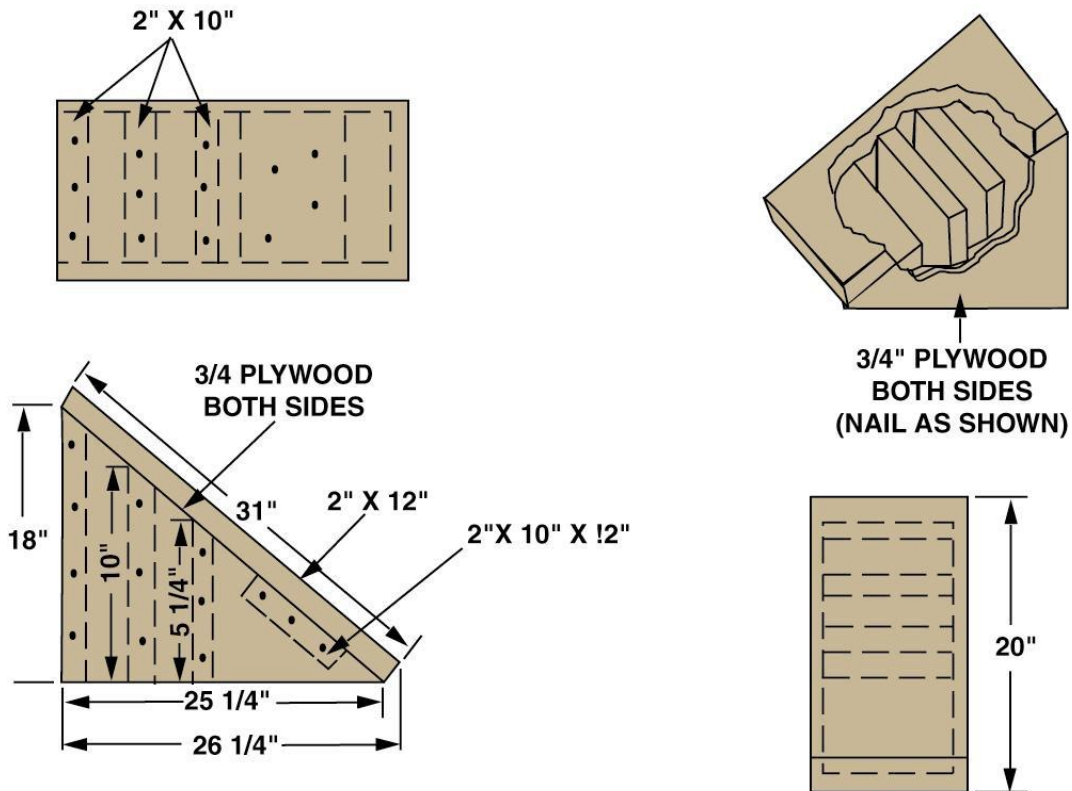

NOTE: AFTER ASSEMBLING THE BLOCK AS SHOWN, LOCATE THE INCLINED FACE OF THE BLOCK AGAINST THE TRACK, EVEN WITH THE INBOARD EDGE, AT THE FRONT OF THE VEHICLE. NEXT, CONSTRUCT 2 END CLEATS: EACH CONSISTING OF 2 PIECES OF 2" X 12" X 24" LUMBER. SECURE THE LOWER PIECE TO THE FLOOR WITH FOUR 20-D (4") NAILS. THEN, CONSTRUCT 2 SIDE CLEATS: EACH CONSISTING OF ONE PIECE OF 2" X 4" X 24" LUMBER. LOCATE ON THE OUTSIDE OF THE BLOCK AND SECURE TO THE FLOOR WITH FOUR 20-D (4") NAILS, (SEE BELOW)

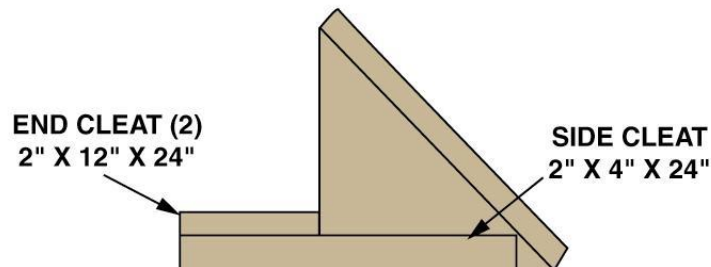

GENERAL INFORMATION
PATTERN 31

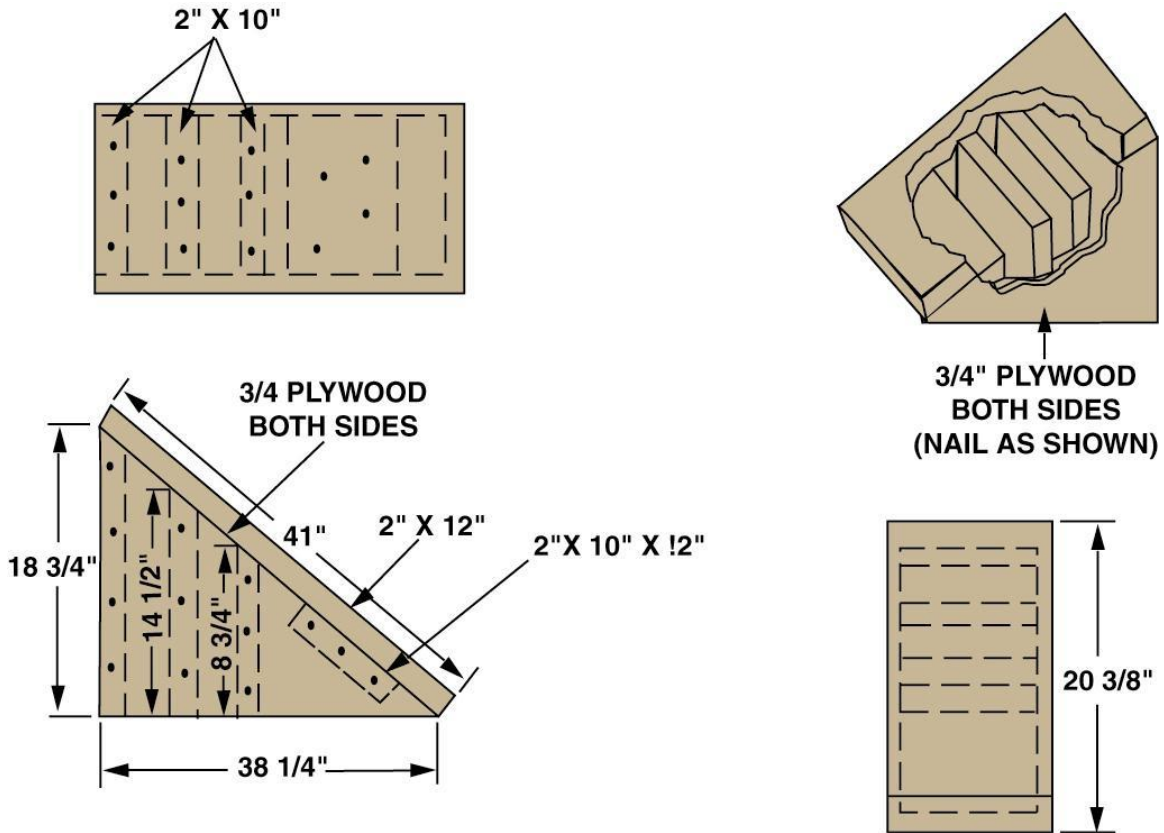

NOTE: AFTER ASSEMBLING THE BLOCK AS SHOWN, LOCATE THE INCLINED FACE OF THE BLOCK AGAINST THE TRACK, EVEN WITH THE INBOARD EDGE, AT THE REAR OF THE VEHICLE. NEXT, CONSTRUCT 2 END CLEATS: EACH CONSISTING OF 2 PIECES OF 2" X 12" X 24" LUMBER. SECURE THE LOWER PIECE TO THE FLOOR WITH FOUR 20-D (4") NAILS AND THE TOP PIECE TO THE ONE BELOW, WITH FOUR 20-D (4") NAILS. THEN, CONSTRUCT 2 SIDE CLEATS: EACH CONSISTING OF ONE PIECE OF 2" X 4" X 24" LUMBER. LOCATE ON THE OUTSIDE OF THE BLOCK AND SECURE TO THE FLOOR WITH FOUR 20-D (4") NAILS. (SEE BELOW)

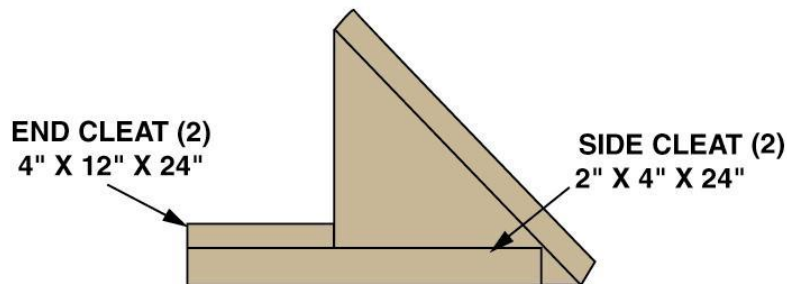

GENERAL INFORMATION
PATTERN 89

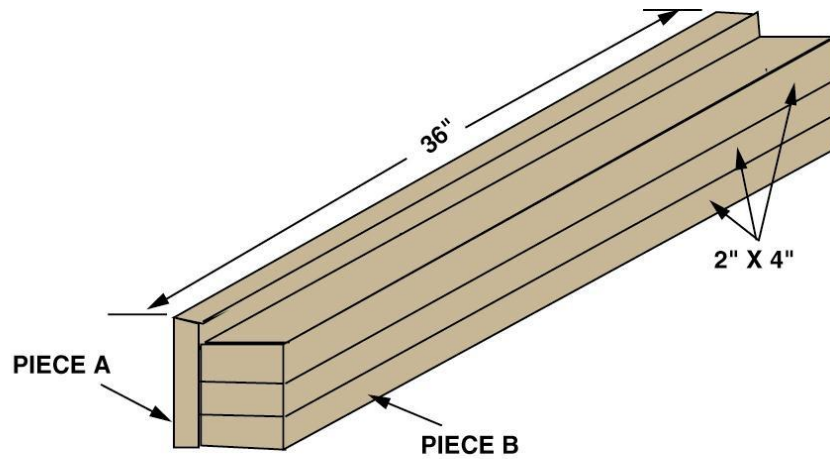

NOTE: NAIL PIECE A TO PIECE B WITH FIVE 12-D (3 ¼") NAILS. NAIL PIECE B TO THE CAR FLOOR WITH FIVE 20-D (4") NAILS. NAIL THE OTHER 2" X 4" PIECES TO THE ONE BELOW IN THE SAME MANNER

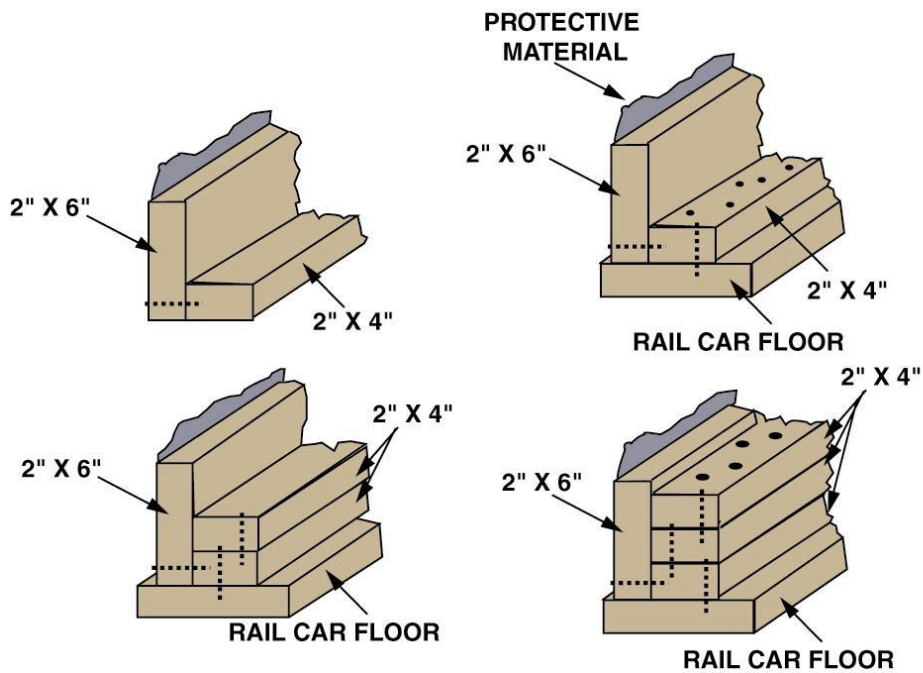

GENERAL INFORMATION

PATTERN 90 AND 91

NOTE: PATTERN 90 HEIGHT, USING DRESSED LUMBER DIMENSIONED AS SHOWN, WILL BE ABOUT 51 5/8"

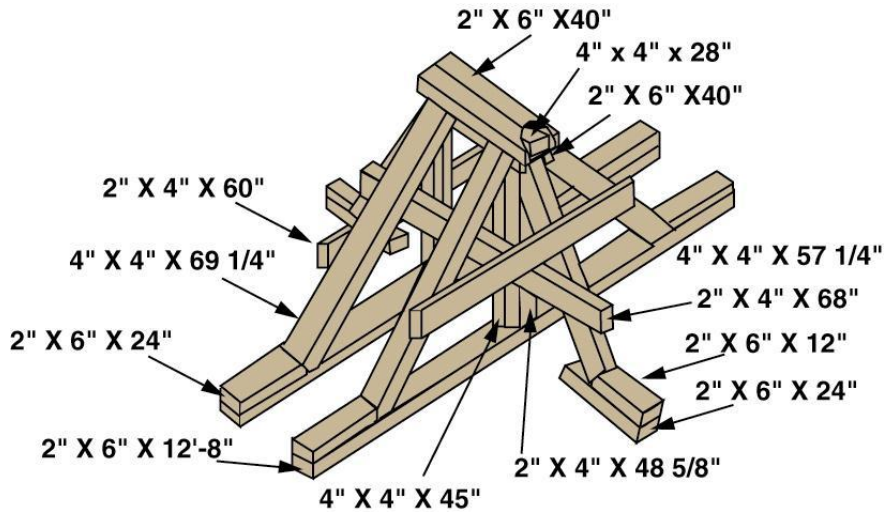

NOTE: PATTERN 91 HEIGHT, USING DRESSED LUMBER DIMENSIONED AS SHOWN, WILL BE ABOUT 28 1/8"

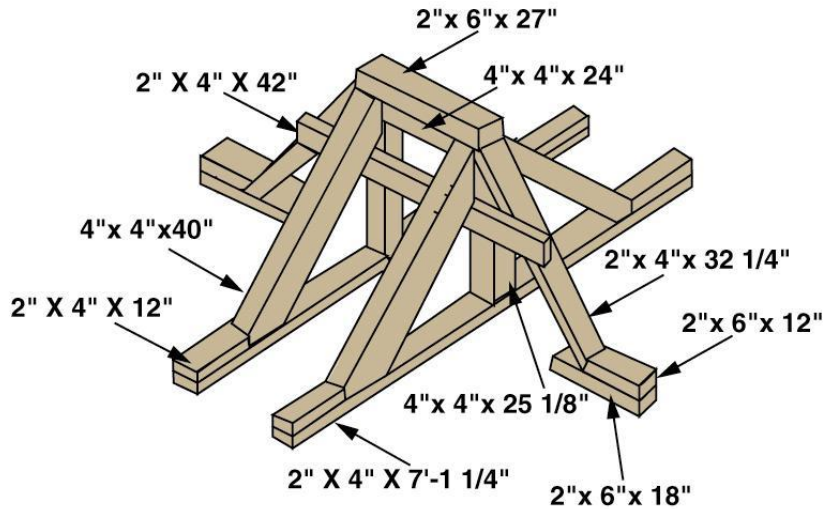

NOTE: LENGTH OF SUPPORT MEMBERS AND OTHER COMPONENTS MAY VARY TO SUIT TRAILER TYPE AND HEIGHT.

GENERAL INFORMATION
LATERAL BLOCKING

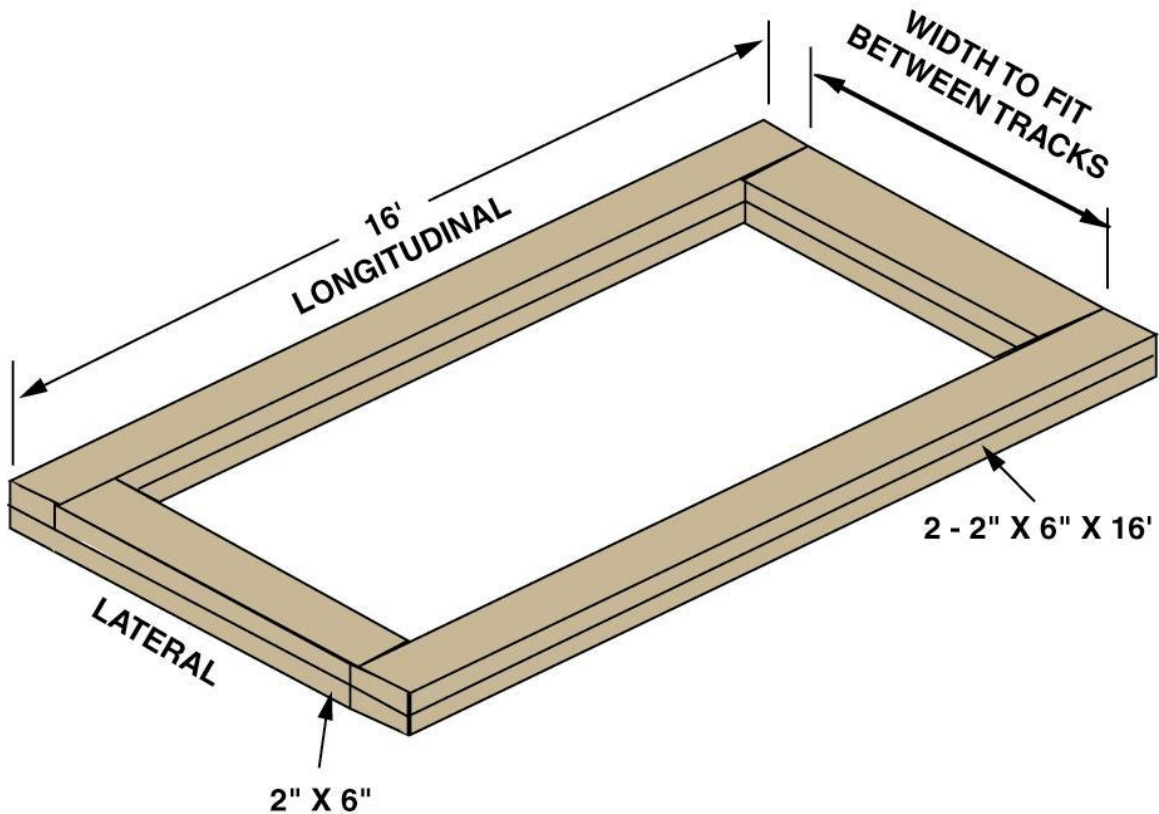

NOTE: FRAMEWORK TO CONSIST OF 4 PIECES OF LUMBER 2" X 6" X 16". LOCATE LOWER PIECES ON CAR FLOOR AGAINST INSIDE EDGE OF EACH CRAWLER THREAD. SECURE TO CAR FLOOR WITH TWELVE 20-D (4") NAILS. SECURE TOP PIECE TO LOWER PIECE IN LIKE MANNER. APPLY NAILS IN STRAGGERED PATTERN. FOUR PIECES OF 2" X 6" LUMBER CUT-TO-FIT SHALL BE PLACED BETWEEN THE LONGITUDINAL PIECES. SECURE LOWER PIECES TO CAR FLOOR WITH FOUR 20-D (4") NAILS. SECURE TOP PIECE TO LOWER PIECE IN LIKE MANNER.

GENERAL INFORMATION
ROAD WHEEL BLOCK

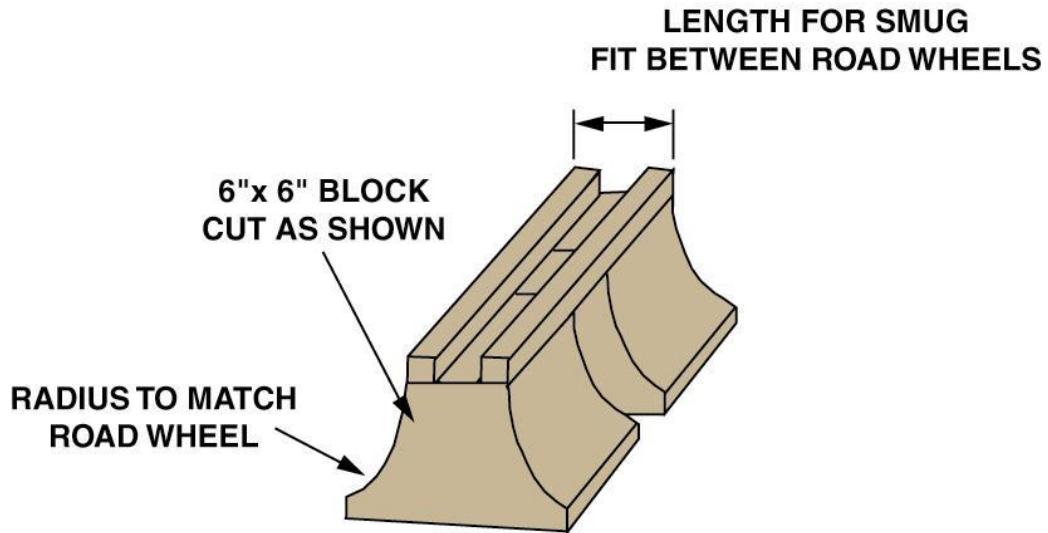

NOTE: 2" X 4" - TWO PLACES IF POSSIBLE (SKETCH 1) TIGHT AGAINST ROAD WHEELS. FASTEN EACH WITH FOUR 20-D (4") NAILS AFTER PUTTING 6" X 6" BLOCKS IN PLACE.

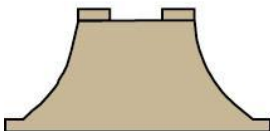

SKETCH 1

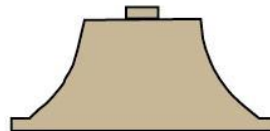

SKETCH 2

NOTE: IF TWO 2" X 4" PIECES WILL NOT FIT AS SHOWN IN SKETCH 1, USE ONE 2" X 4" AS SHOWN IN SKETCH 2. FASTEN WITH FOUR 20-D (4") NAILS AFTER PUTTING 6" X 6" BLOCKS IN PLACE.